

ANT-4GCombo5

GNSS + 4G LTE MIMO + WIFI MIMO Antenna



Outstanding Features

- **COMBO 5-in-1 ANTENNA:** 2x 4G LTE MIMO, 2x Wi-Fi and 1x GNSS Antenna; Screw mount; Cable length 3 meters (10 ft)
- **IP67 WATERPROOF:** Outdoor Roof Type, water and dust-resistant for ultimate outdoor reliability.
- **GLOBAL 4G LTE RANGE:** Works in most countries in the world with frequency range: 698~960MHz/1710~2690MHz; 2x SMA Male Connector.
- **DUAL BAND Wi-Fi:** Frequency range: 2400~2483.5MHz/4900~5825MHz; 2x RP-SMA Male Connector.
- **GNSS ANTENNA:** 1x SMA Male Connector. Frequency range: 1575.42 - 1610 MHz.
- **COMPATIBLE ROUTERS:** Work with most 4G LTE cellular routers in the market with 2/3/5 antenna interfaces, like Linovision IOT-R32, Inhand IR302/IR305, Teltonika RUT241, RUT240, RUT360, RUT956, RUTX11 (Equivalent to Teltonika PR1KCO28).

Specification

Model	ANT-4GCombo5	
GPS&GLONASS Antenna	Frequency Range	1575.42~1610MHz
	Polarization	RHCP
	Impedance	50Ω
	Gain	28±2dB
	Noise Figure	≤1.5dB
	Supply Voltage	3~5V DC
	Current Consumption	< 15mA
	V.S.W.R	< 2.0
LTE Antenna MIMO	Frequency Range	698~960MHz/1710~2690MHz
	V.S.W.R	< 3.0
	Polarization	Linear
	Gain	3dBi
	Impedance	50Ω
WIFI Antenna MIMO	Frequency Range	2400~2483.5MHz/4900~5825MHz
	V.S.W.R	< 2.5
	Polarization	Linear
	Gain	2dBi
	Impedance	50Ω
Mechanical	Cable	RG174
	Connector	SMA or others
	Radome Material	ABS
	Mounting Method	Screw

**Disclaimer: Technical specifications may subject to change without prior notice*

Specification

Environmental	Operating Temperature	-40°C to +85°C (-40°F to 185°F)
	Relative Humidity	Up to 95%
	Ingress Protection	IP67 (exclude cable outlet)
	Vibration	10 to 55Hz with 1.5mm amplitude 2hours
	Environmentally Friendly	ROHS Compliant

Radiation Patterns

GPS Antenna

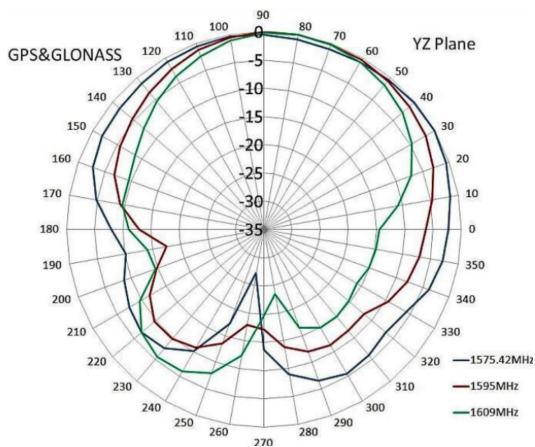
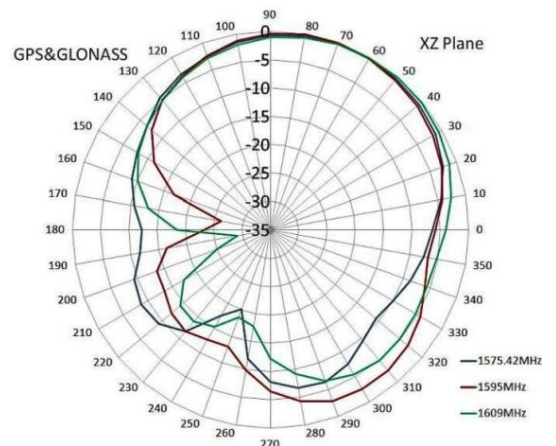
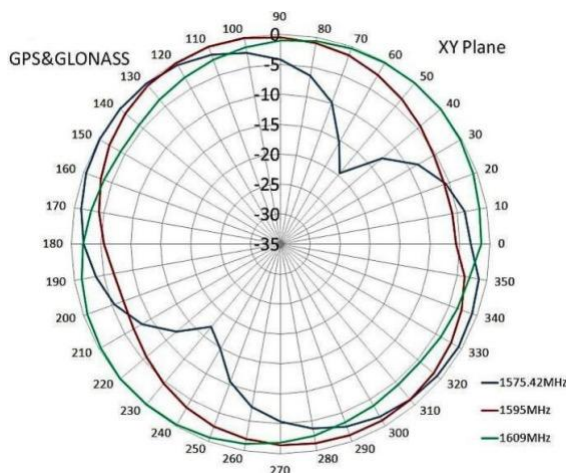

**Disclaimer: Technical specifications may subject to change without prior notice*

WIFI Antenna

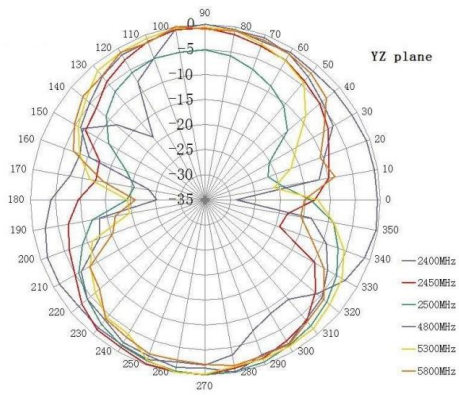
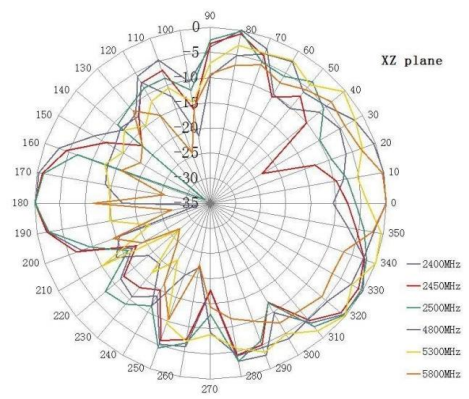
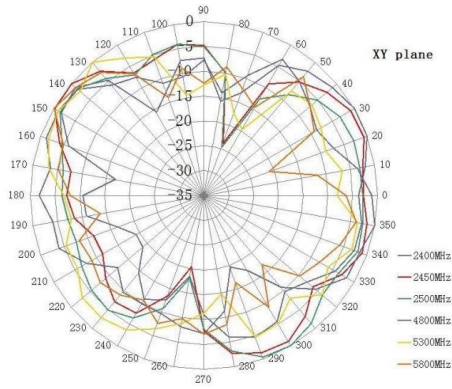

**Disclaimer: Technical specifications may subject to change without prior notice*

LINOVISION

Dimension



Interface

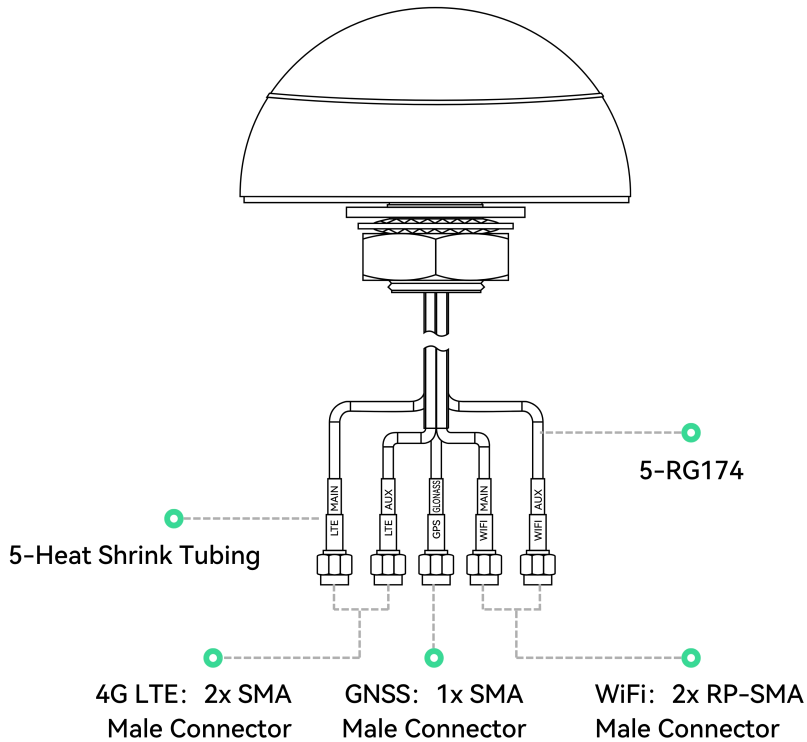

Installation

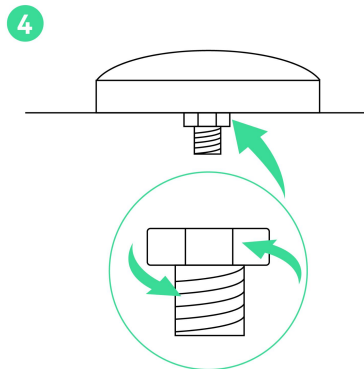
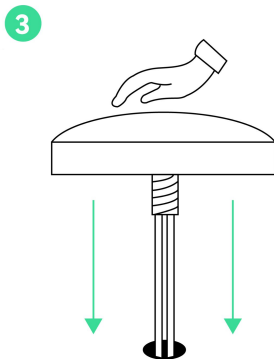
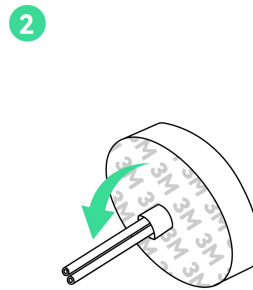
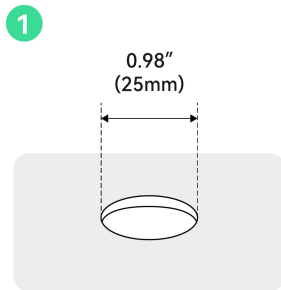

Package Contents



ANT-4GCombo5



User Manual