

LINOVISION

Gigabit 30W IEEE802.3af/at PoE Injector
POE-IN3001G
Quick Guide (V1.0/2025-12-19)



Quick Guide

Package Contents



POE-IN3001G



Power Cord



Quick Guide

Interface

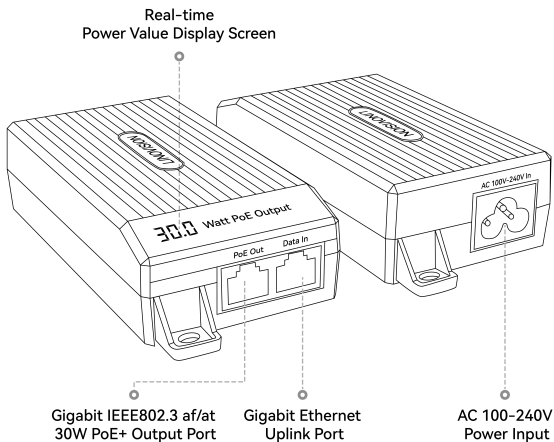

Installation

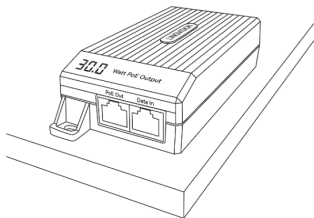

Desktop

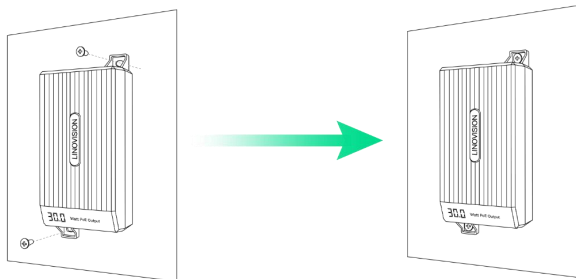

Wall-mounting

Connection Diagram

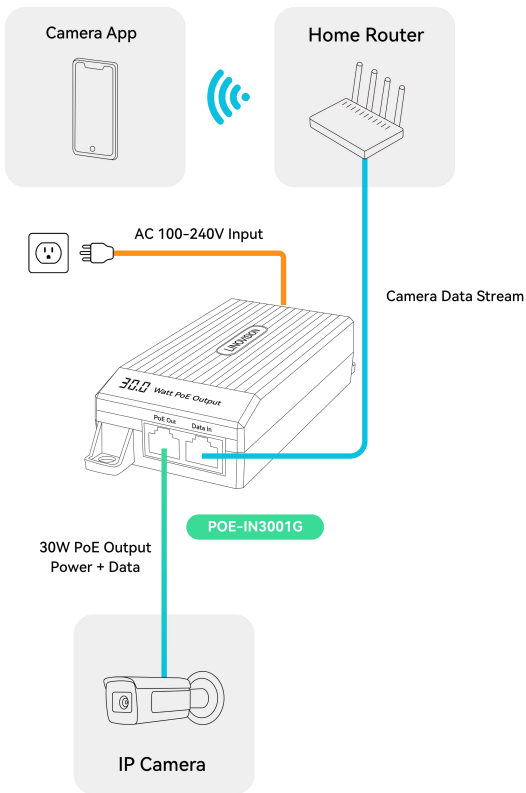

Specifications

Hardware	
Dimensions (W*D*H)	63*139*33 mm (2.48*5.47*1.30 in)
Weight	192g
Installation	Wall Mount
Material	ABS
Interface	
LED Digital Display	PoE Output Power
Ethernet Ports	1* 10/100/1000Mbps PoE+ RJ45 Port, PoE out 1* 10/100/1000Mbps RJ45 Port, Data in
AC Power Socket	IEC 60320 C6
Power Input	
AC Input	100 to 240V AC, 50 to 60 Hz
PoE	
PoE Standard	IEEE 802.3 af/at
Pin Assignment	Mode A, 1/2(-)/3/6(+)
PoE Output	Max. 30W
Environment	
Operating Temperature	14°F to 131°F (-10°C to 55°C)
Storage Temperature	-40°F to 158°F(-40°C to 70°C)
Operating Humidity	Max. 90%, non-condensing
Storage Humidity	Max. 90%, non-condensing