

LINOVISION

Gigabit 60W IEEE802.3bt PoE Injector  
POE-IN6001G2  
Quick Guide (V1.0/2026-1-5)



Quick Guide

## Package Contents



POE-IN6001G2



Power Cord



Quick Guide

## Interface

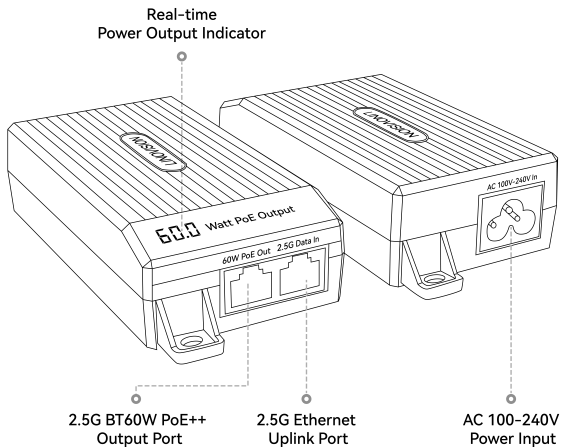

# Installation

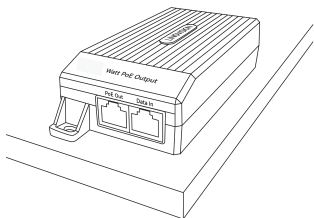

Desktop

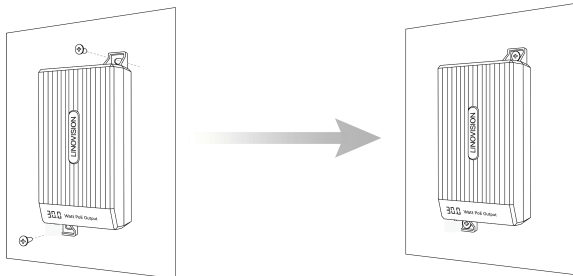

Wall-mounting

# Connection Diagram

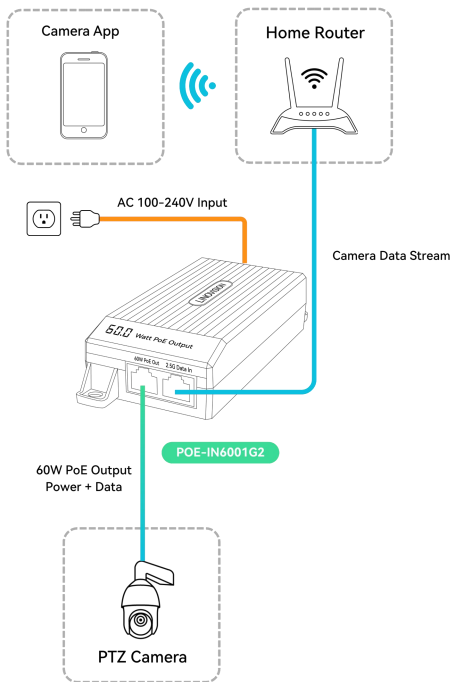

# Specifications

<b>Hardware</b>	
Dimensions (W*D*H)	63*139*33 mm (2.48*5.47*1.30 in)
Weight	192 g (0.423lb)
Installation	Wall Mount
Material	ABS
<b>Interface</b>	
LED Digital Display	PoE Output Power
Ethernet Ports	1* 10/100/1000/2500 Mbps PoE+ RJ45 Port, PoE out 1* 10/100/1000/2500 Mbps RJ45 Port, Data in
AC Power Socket	IEC 60320 C6
<b>Power Input</b>	
AC Input	100 to 240V AC, 50 to 60 Hz
<b>PoE</b>	
PoE Standard	IEEE 802.3 af/at/bt
Pin Assignment	Full Pair PoE (4-Pair), 1/2 (-), 3/6 (+), 4/5 (+), 7/8 (-)
PoE Output	Max. 60W
<b>Environment</b>	
Operating Temperature	14°F to 131°F (-10°C to 55°C)
Storage Temperature	-40°F to 158°F(-40°C to 70°C)
Operating Humidity	Max. 90%, non-condensing
Storage Humidity	Max. 90%, non-condensing