

POE-IN9001G10

90W 10G PoE Injector with LED Indicator



Outstanding Features

- **BT 90W PoE++ INJECTOR:** Converts a single Ethernet port into an IEEE 802.3bt 90W PoE++ output for PTZ cameras, PoE lighting, digital signage, and Wireless APs. Backward compatible with IEEE 802.3af/at.
- **Real-Time PoE Power Display:** Built-in digital LED display shows real-time PoE power output, allowing quick and intuitive status checks and easier troubleshooting.
- **10G HIGH SPEED:** Supports 10M/100M/1G/2.5G/10G auto-negotiation, delivering full 10Gbps bandwidth over a single Ethernet port for WIFI 7 AP, 10G NAS, 4K Video and other high-bandwidth PoE devices.
- **Advanced GaN Architecture:** Adopt advanced GaN material for faster and more stable charging.
- **3 YEARS WARRANTY:** Backed by a 3-year LINOVISION manufacturer warranty for long-term reliability and professional technical support.
- **COMPACT DESIGN:** Compact size of 5.47" × 2.48" × 1.30" (139 × 63 × 33 mm) fits easily into wall-mount brackets, junction boxes, and outdoor waterproof enclosures.
- **PLUG-N-PLAY:** Simply connect the Ethernet cables and power cord, no configuration required.

Interface

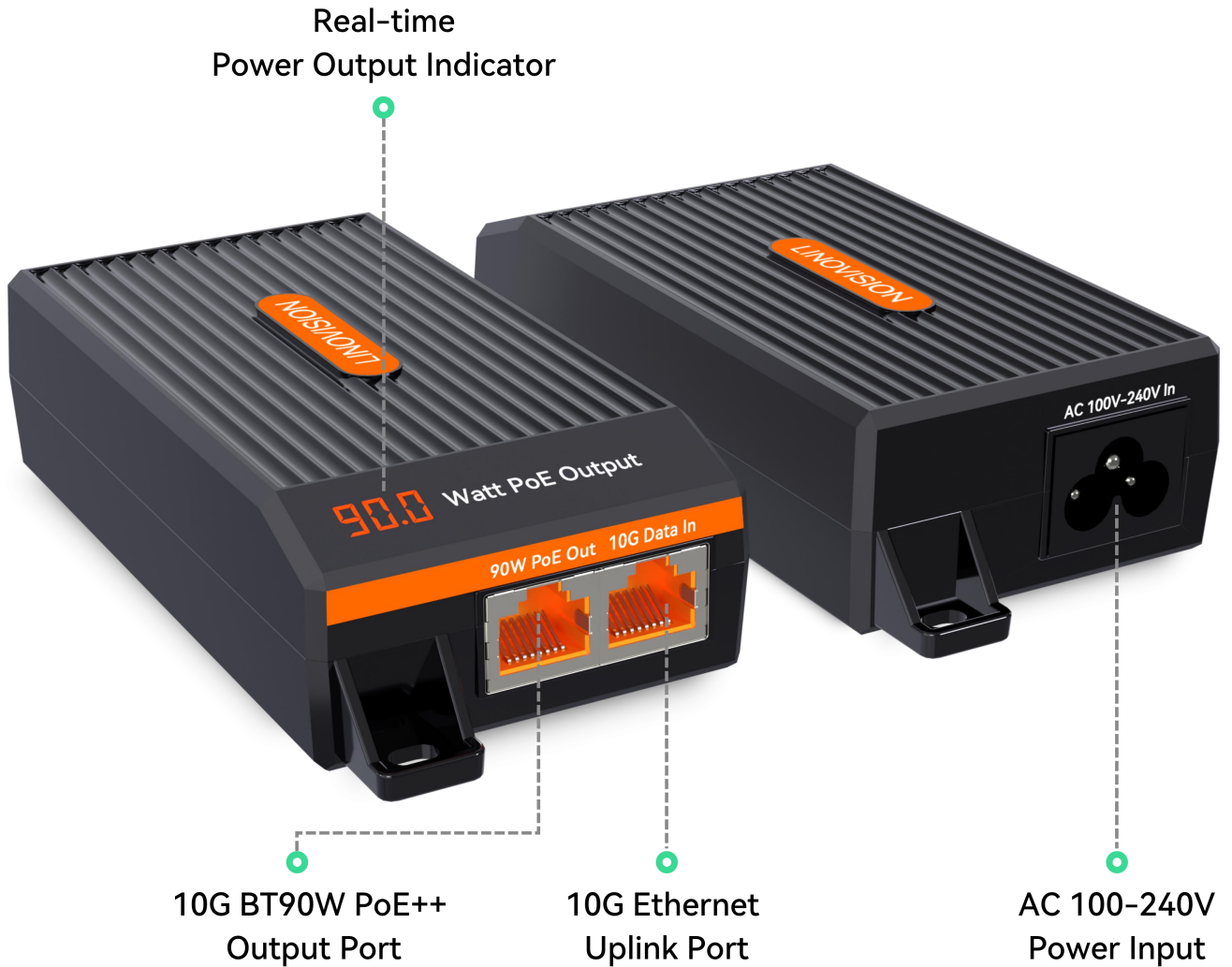

**Disclaimer: Technical specifications may subject to change without prior notice*

Connection Diagram

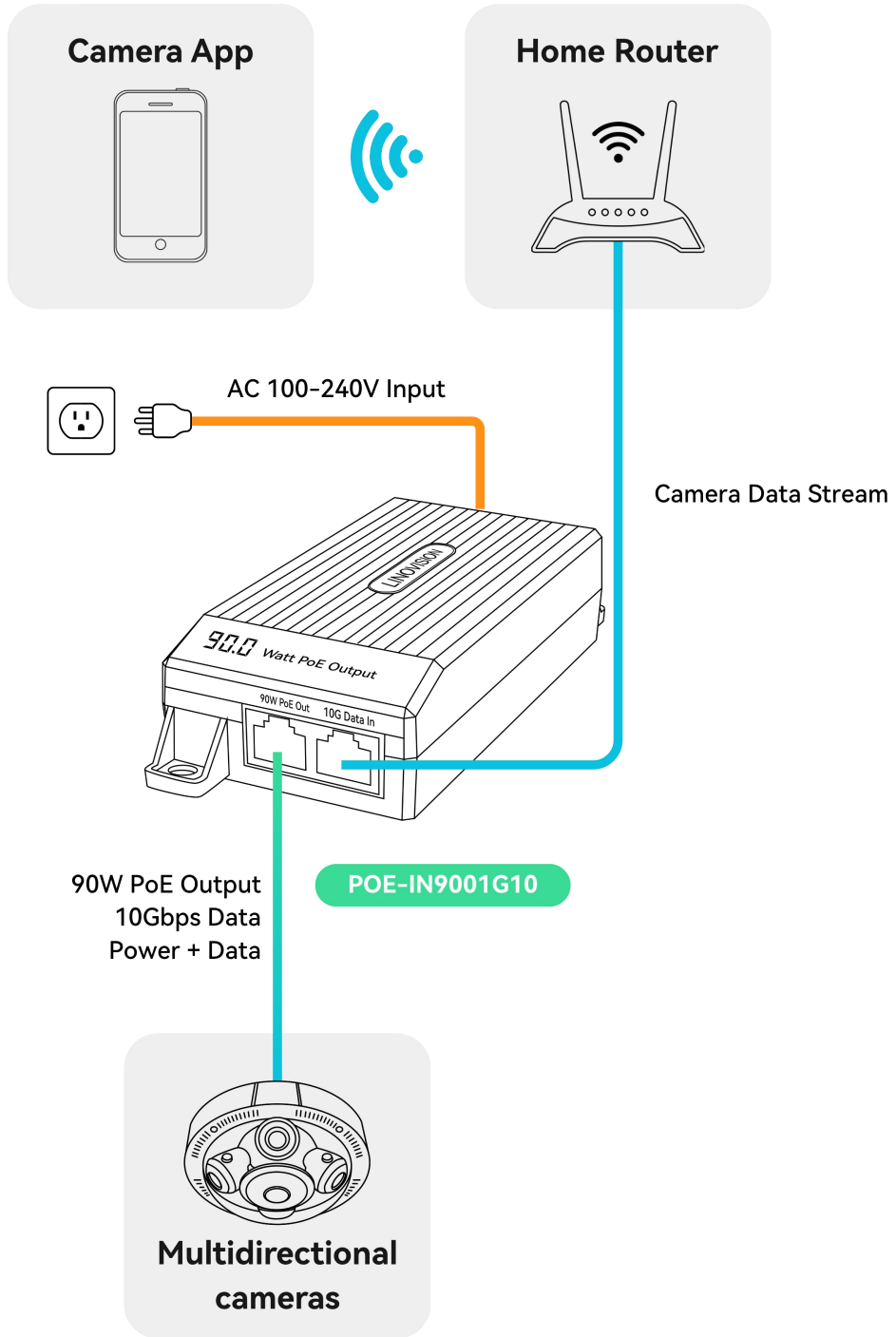

**Disclaimer: Technical specifications may subject to change without prior notice*

Dimension



Weight: 192g (0.423lb)

Installation

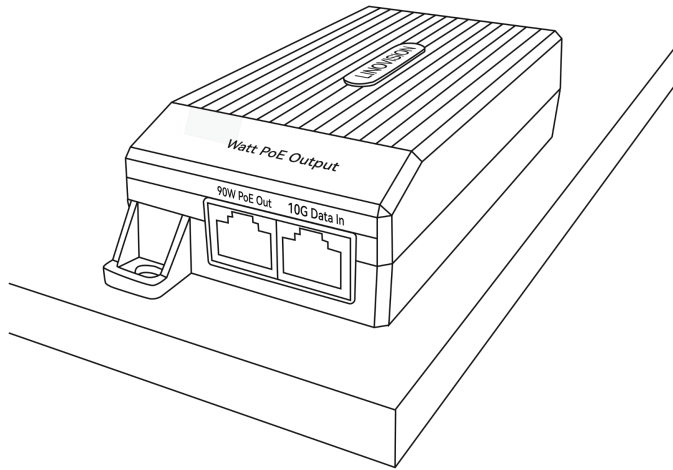

Desktop

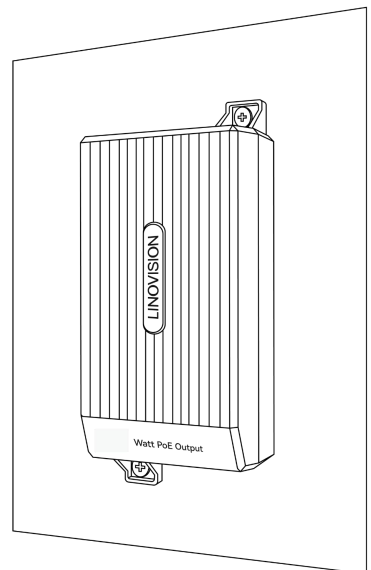
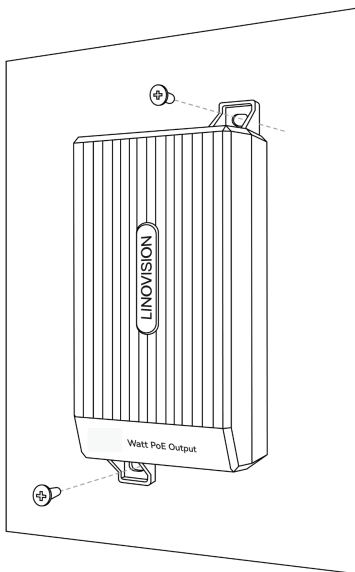

Wall-mounting

Package Contents



POE-IN9001G10



Power Cord



Quick Guide

Specification

Hardware	
Dimensions (W*D*H)	63 × 139 × 33 mm (2.48 × 5.47 × 1.30 in)
Weight	192 g (0.423 lb)
Installation	Wall Mount
Material	ABS
Interface	
LED Digital Display	PoE Output Power
Ethernet Ports	1 × 10/100/1000M,2.5G,10G bps PoE++ RJ45 Port, PoE out 1 × 10/100/1000M,2.5G,10G bps RJ45 Port, Data in
AC Power Socket	IEC 60320 C6
Power Input	
AC Input	100 to 240V AC, 50 to 60 Hz
PoE	
PoE Standard	IEEE 802.3 af/at/bt
Pin Assignment	Full Pair PoE (4-Pair), 1/2 (-), 3/6 (+), 4/5 (+), 7/8 (-)
PoE Output	Max. 90W
Environment	
Operating Temperature	14°F to 131°F (-10°C to 55°C)
Storage Temperature	-40°F to 158°F (-40°C to 70°C)
Operating Humidity	Max. 90%, non-condensing
Storage Humidity	Max. 90%, non-condensing

**Disclaimer: Technical specifications may subject to change without prior notice*