

POE-SP1224POE(12V)

Industrial Gigabit 30W PoE Splitter with DC12V Output and 12V Passive PoE Output



Outstanding Features

- **30W PoE Splitter:** Split IEEE802.3af/at PoE to DC and Data Output (or Passive PoE).
- **DC12V Output:** For Non-POE IP cameras, access reader terminals, Routers, etc.
- **Optional Passive PoE Output:** Provide forced Passive 12V PoE output for Wireless bridges, wireless AP, or other terminals. (Not recommended for regular devices).
- **Gigabit Speed:** All ports support 10M/100M/1000Mbps transmission bandwidth.
- **Compact Dimension:** Full metal design, compact dimension 3.26" x 2.09" x 1.02"(82.7mm x 53mm x 25.8mm), width measures 2.72" (69mm) when including the DIN-rail mounting bracket and DC terminal block.

Specifications

Mechanical Specs	
Dimension (W × D × H)	82.7 × 53 × 25.8 mm (3.26 × 2.09 × 1.02 in)
Weight	117g (0.258 lb)
Material	Aluminum
Installation	DIN-Rail/Wall-Mount
Interfaces	
PoE Input	Ethernet Port: 1 * 10/100/1000Base-T RJ45 PoE Standard: IEEE 803.2af/at Power Supply: Mode A & Mode B
Passive PoE Output	Ethernet Port: 1 * 10/100/1000Base-T RJ45 Power Pin Assignment: 4/5 (+), 7/8 (-)
Passive PoE DIP Switch	Passive PoE or Data only output
DC Output	5.5/2.1 mm Female DC Jack and Terminal Block Connector (Dual-Use)
DC DIP Switch	12 VDC and Passive PoE voltage output
Grounding	Grounding Terminal
Environment	
Operating Temperature	-40°C to 75°C (-40°F to 167°F)
Storage Temperature	-40°C to 85°C (-40°F to 185°F)
Humidity	0% to 95% non-condensing
Surge Protection	1500 V
Electrostatic Standard	HBM ±2000 V, CDM ±750 V

Interface

Front View

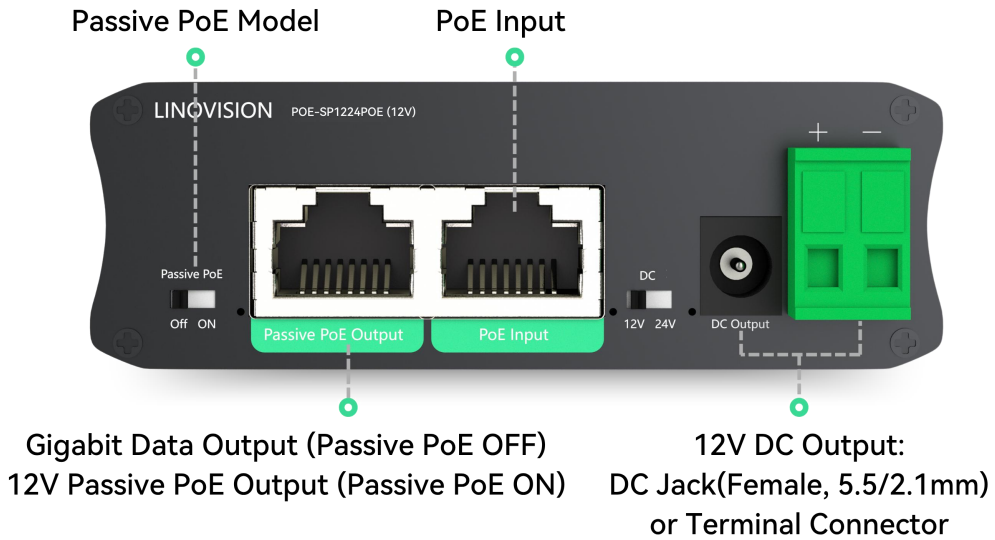

Rear View

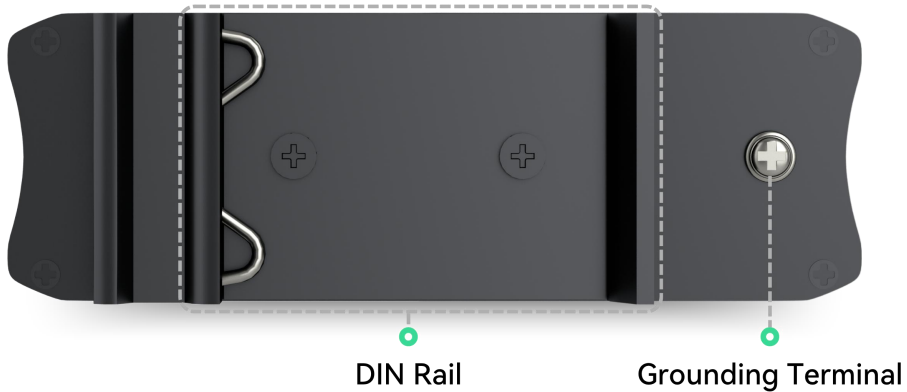

Noted: Passive PoE and DC output operate at the same voltage and the total power is up to 25W.

Dimension

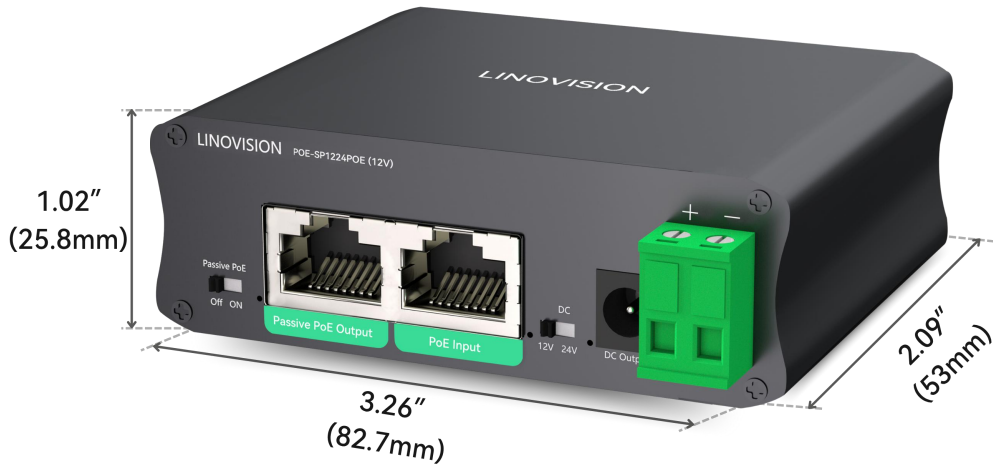

(2.72" width includes DIN rail mounting bracket and DC output port)

Weight: 117g (0.258 lb)

Connection Diagram

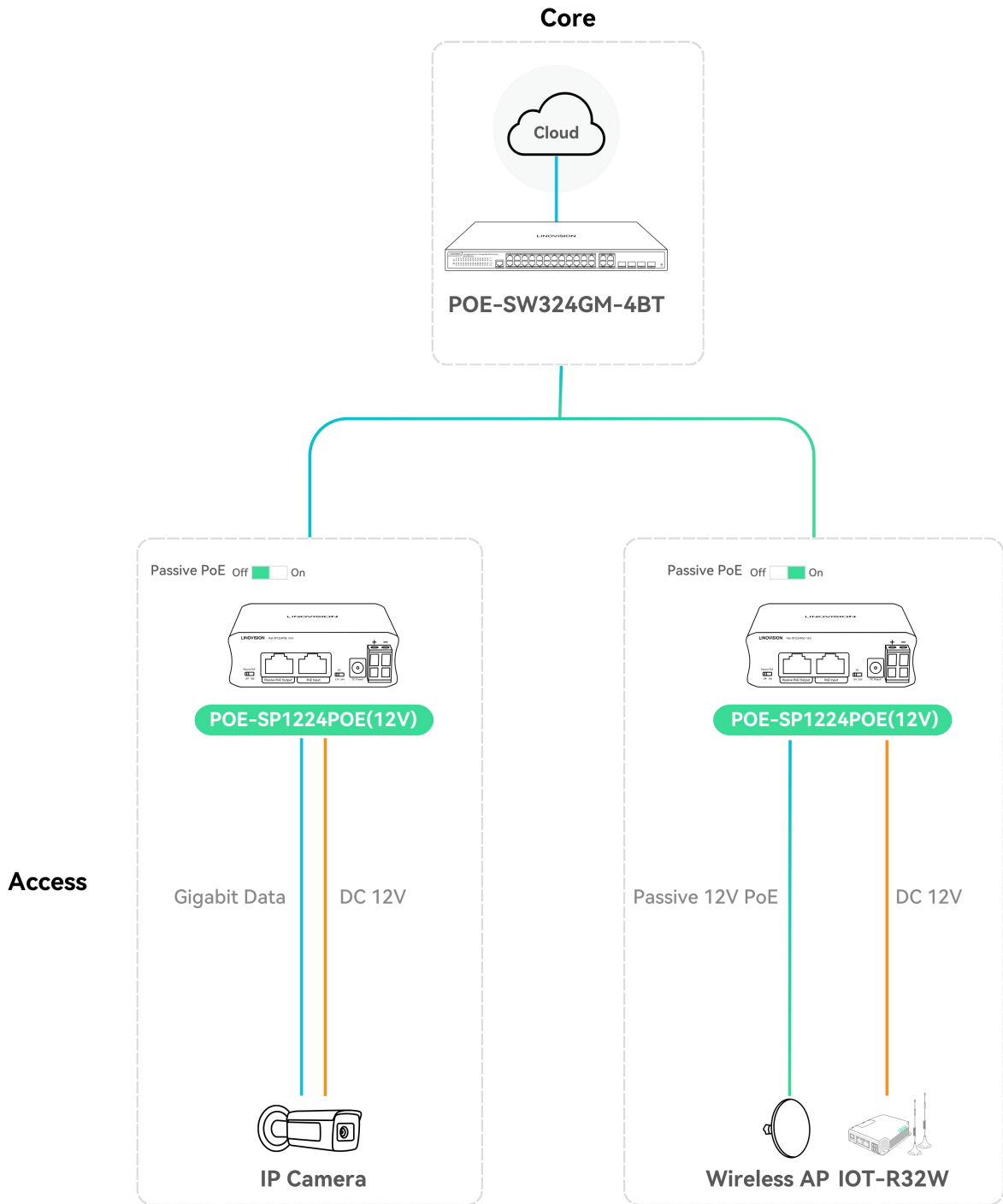

Installation

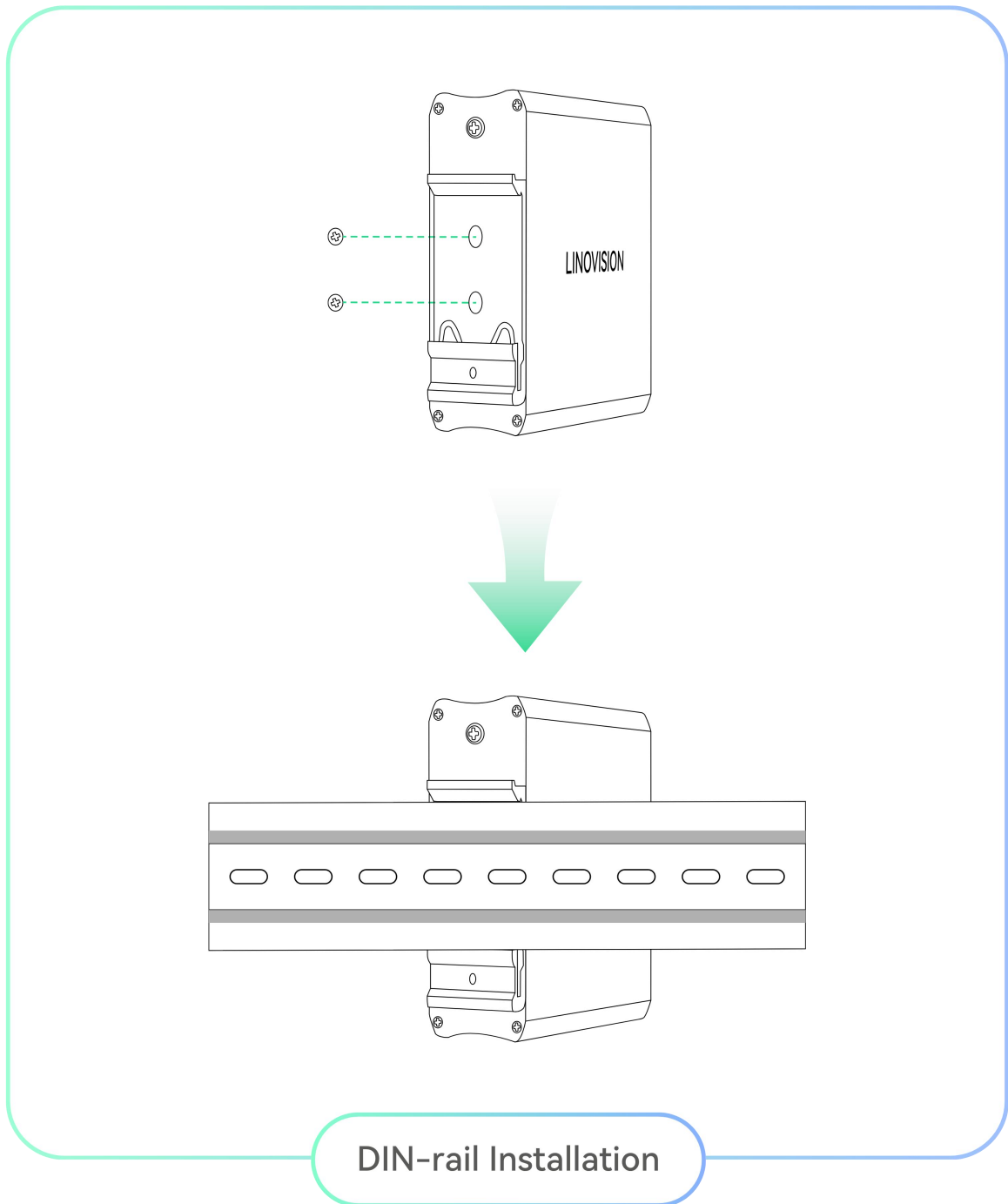

**Disclaimer: Technical specifications may subject to change without prior notice*

Package Contents



POE-SP1224POE(12V)



DIN-Rail Mounting Accessory



User Manual