

UltraReach EOC2

New-Generation PoE & Ethernet over Coax Converter



Outstanding Features

- **IP & PoE over Coax:** Upgrade analog CCTV to an IP surveillance system using existing coaxial cables (RG59/RG6/RG11). Supports IEEE 802.3af/at PoE.
- **UltraReach PoE Transmission up to 3300ft:** Delivers PoE power and data up to 3300ft (1000m) over coax or twisted pair using LINOVISION UltraReach technology.
- **Enhanced Heat Dissipation for Long-Term Stability:** Upgraded internal aluminum base improves thermal performance and ensures stable, long-term operation under continuous use.
- **Plug-n-Play:** No configuration required. Connect the EOC Receiver to a PoE switch or injector, then link it to the EOC Transmitter via coaxial or twisted pair cable. IP cameras or VoIP phones receive PoE power and data instantly.
- **IP & PoE over Twist Pair:** Includes two BNC-to-Twist-Pair adapters for PoE + data transmission over two-wire cables. Supports 100Mbps up to 100m and 10Mbps up to 453m.
- **Ideal for Elevator Applications:** Delivers PoE power and IP data through existing traveling cables (coax or two-wire) where Ethernet and power are unavailable, with no rewiring required.
- **Point to Point Connection Only:** Operates in dedicated point-to-point mode (MoCA-style) for video, audio, data, and control signals over coax or twist pair.
- **Compatibility Notice:** The upgraded version does not support EoC switches. Choose the classic version for EoC switches.

Interface (Transmitter & Receiver)

Standard BNC female
(bayonet-style) connector



UltraReach EOC-T2

Standard BNC female
(bayonet-style) connector



UltraReach EOC-R2

**Disclaimer: Technical specifications may subject to change without prior notice*

LINOVISION

Connection Diagram

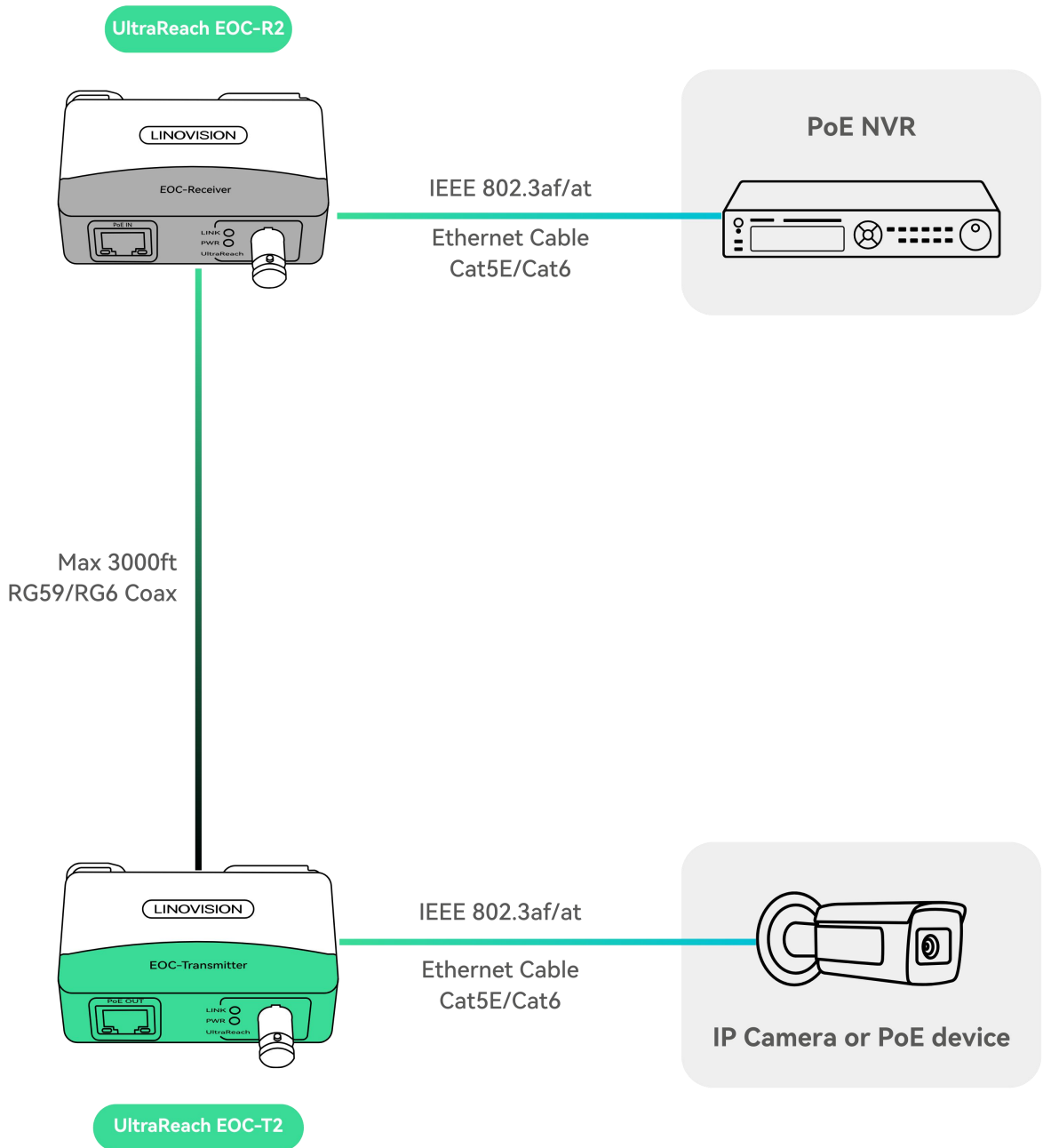

**Disclaimer: Technical specifications may subject to change without prior notice*

Dimension

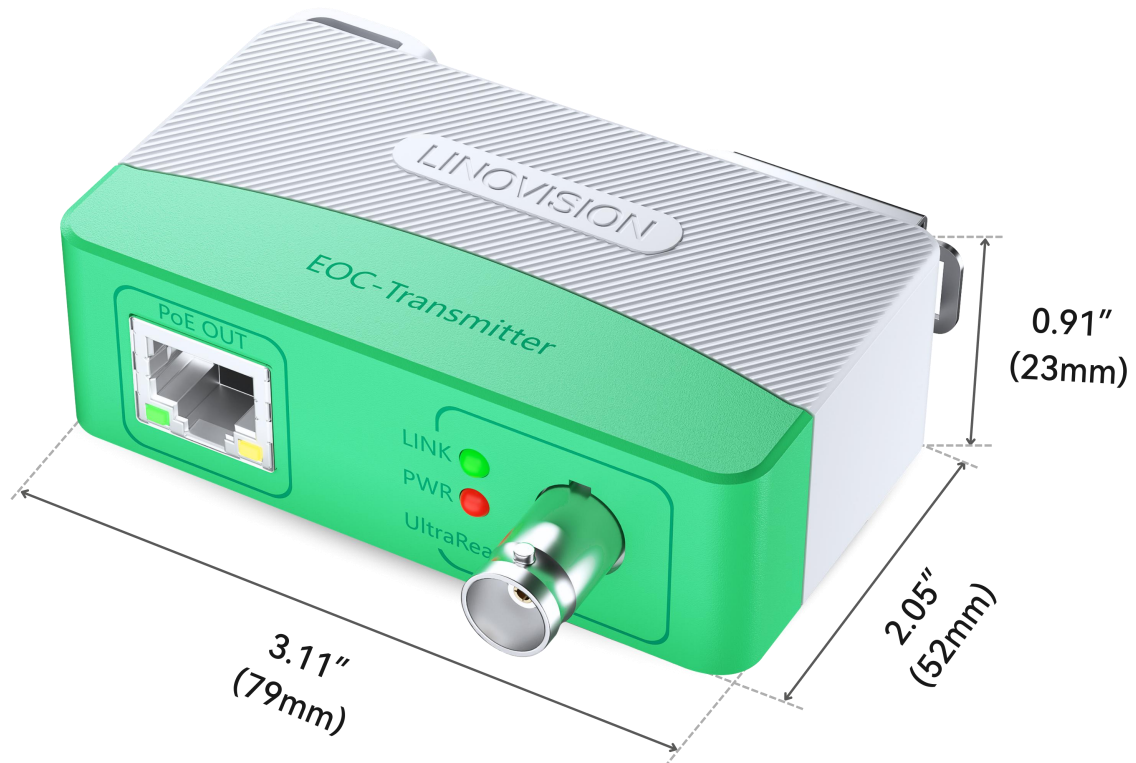

Weight: 61g (0.134 lb)

Installation

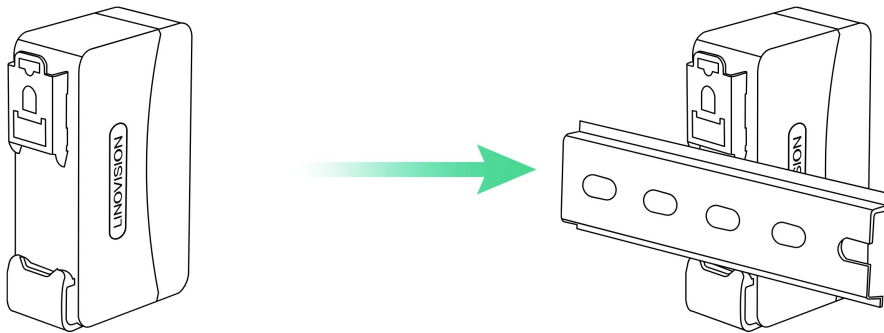
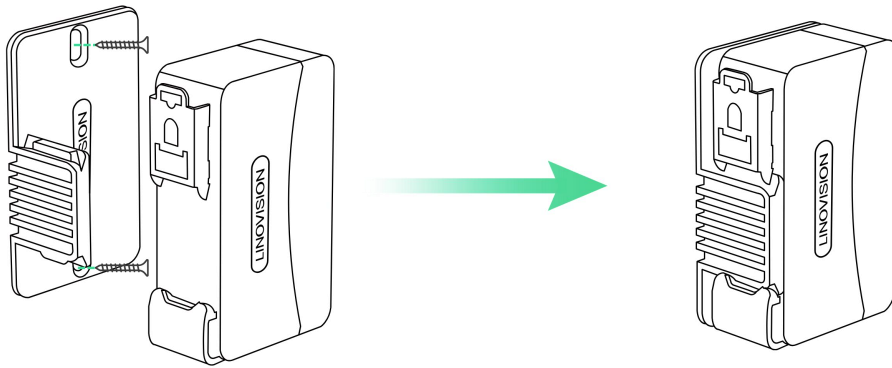

DIN-rail Installation & Wall Mounting

Package Contents

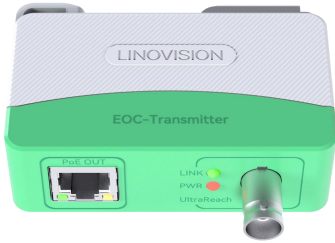

**EOC-T2
(Transmitter)**



**EOC-R2
(Receiver)**



**Wall Mounting
Accessory**



**BNC to Twist Pair
Connector**



Screw Bag



Quick Guide

Specification

Hardware		
Model	UltraReach EOC-T2 (Transmitter)	UltraReach EOC-R2 (Receiver)
Function Port	1 * 10/100 Mbps Base-TX 1 * BNC	
Power Consumption	<2W	
Transmission Bandwidth	RG59 coaxial cable: 400m/100Mbps, 1000m/10Mbps	
PoE Protocol	The EOC2 operates as a PoE PD on the Receiver side and a PoE PSE on the Transmitter side, enabling PoE power pass-through over coaxial cable. PoE power and Ethernet data are first received by the Receiver, then regenerated and output by the Transmitter to the downstream device.	
	Transmitter (PSE): Delivers IEEE 802.3af/at-compliant PoE power to downstream powered devices (IP cameras, etc.), supporting IEEE 802.3af/at or 48 V Passive PoE (power on pairs 1/2 (+), return on 3/6 (-)).	Receiver (PD): Accepts PoE input from an upstream PoE source, with automatic support for PoE Mode A or Mode B. A 30 W PoE source is recommended for stable operation.
Network Standard	IEEE802.3, IEEE802.3u, IEEE802.3x	
Capatible Cables	RJ45 Port: Cat 5e, Cat 6 BNC Port: RG59, RG6, RG11; UTP; twisted pair	
Lightning Protection	Common Mode 6KV Differential Mode 3KV	
Operating Temperature	-30°C to 65°C (-22°F to 149 °F)	
Operating Humidity	5%-95%	
Weight	61 g (0.134 lb)	
Dimension (W×D×H)	79 * 52 * 23 mm (3.11 * 2.05 * 0.91 in)	

Transmission Performance

Transmission Distance		Performance
100 m (330 ft)	Bandwidth	100 Mbps
	Load Capacity	21 W
400 m (1300 ft)	Bandwidth	100 Mbps
	Load Capacity	9 W
1000 m (3280 ft)	Bandwidth	10 Mbps
	Load Capacity	4W
*Base on RG59 Cable & 48V PoE Input		